

# PORTABLE AIR CONDITIONER

INSTRUCTION FOR USE  
SAVE THESE INSTRUCTIONS

## CLIMATISEUR PORTATIF

MODE D'EMPLOI  
CONSERVEZ CE MODE D'EMPLOI

## CLIMATIZADOR PORTÁTIL

INSTRUCCIONES DE USO  
CONSERVE ESTAS INSTRUCCIONES  
LEA CUIDADOSAMENTE ESTE  
INSTRUCTIVO ANTES DE USAR SU APARATO

## PAC WE 110 - WE125 - WE130

Register this product online and receive a free trial issue of Cook's Illustrated. Visit [www.delonghiregistration.com](http://www.delonghiregistration.com). Visit [www.delonghi.com](http://www.delonghi.com) for a list of service centers near you.

Enregistrez ce produit en ligne et recevez un numéro gratuit de Cook's Illustrated. Visitez [www.delonghiregistration.com](http://www.delonghiregistration.com). Visitez [www.delonghi.com](http://www.delonghi.com) pour y voir une liste des centres de réparation proches de chez vous.

Registre este producto en línea y reciba un ejemplar gratis de Cook's Illustrated. Visite [www.delonghiregistration.com](http://www.delonghiregistration.com). Visite [www.delonghi.com](http://www.delonghi.com) para ver la lista de centros de servicios cercanos a usted.

Electronic characteristics/Caractéristiques électroniques/Características electricas

115V~60HZ 1500W



# IMPORTANT SAFEGUARDS

- Use this appliance only as described in this instruction manual.  
As with all electrical equipment, the instructions aim to cover as many eventualities as possible, caution and common sense should be applied when operating and installing this appliance.
- This appliance is designed for home air conditioning and must not be used for other purposes.
- It is dangerous to modify or alter the characteristics of the appliance in any way.
- The appliance must be installed in accordance with national legislation regulating electrical equipment and installations.
- If the appliance requires repair, contact a Service Center authorized by the manufacturer only.  
Repairs carried out by unauthorized personnel may be dangerous.
- The appliance is not intended for use by persons (including children) with reduced physical, sensory or mental capabilities, or lack of experience and knowledge, unless they have been given supervision or instruction concerning use of the appliance by a person responsible for their safety.  
Children should be supervised to ensure that they do not play with the appliance.
- The appliance must be connected to an efficiently grounded electrical system.  
Have your electrical circuit checked by a qualified electrician.
- Do not use extension cables.
- Before cleaning or maintenance, always unplug the appliance from the outlet.
- Never unplug the appliance by pulling on the power cable.
- Do not install the appliance in rooms containing gas, oil or sulphur. Do not install near sources of heat.
- Keep the appliance at least 19.6 inches (50 cm) away from flammable substances (alcohol etc) or pressurised containers (eg aerosol cans).
- Do not rest heavy or hot objects on top of the appliance.
- Clean the air filter at least once a week.
- Avoid using heating appliances near the air conditioner.
- The unit should be transported in a vertical position. If this is not possible secure the unit at an angle, do not lie it horizontally.  
Before transporting the unit, drain the unit. After transportation, wait at least 6 hours before switching the unit on.
- Only run the appliance on a perfectly horizontal surface.
- When putting the appliance away, do not cover with plastic bags.
- The materials used for packaging can be recycled.  
You are therefore recommended to dispose of them in special differentiated waste collection containers.
- At the end of its working life, dispose of the appliance at a specialized collection center.
- If the power cable is damaged, it must be replaced by the manufacturer or an authorized technical service centre in order to avoid all risk.

## ENVIRONMENTAL INFORMATION:

This unit contains fluorinated greenhouse gases covered by the Kyoto Protocol.

Maintenance and disposal must be carried out by qualified personnel only (R410A, GWP=1975).

## ELECTRICAL CONNECTIONS

Before plugging the appliance into the outlet, check that:

- the power supply corresponds to the value indicated on the rating plate on the back of the appliance;
- the outlet and electrical circuit are adequate for the appliance.
- the outlet matches the plug. If this is not the case, have the plug replaced;
- the outlet is a properly grounded 3 hole outlet.

Failure to follow these important safety instructions absolves the manufacturer of all liability.

## **WHAT IS THE WATER-AIR PINGUINO**

During the summer, you feel comfortable at a temperature of between 75 - 80°F (24 - 27°C) with a relative humidity of about 50%.

An air conditioner removes excess moisture and heat from the room where it is located.

Compared with wall mounted models, portable air conditioners have the advantage that they can be moved from one room to another in the home or be transported from one building to another.

Hot air from the room is passed through a coil cooled by refrigerant gas. Excess heat and moisture are removed before the air is re-emitted into the room.

In single unit models, a small part of this air is used to cool the refrigerant gas and then, when hot and damp, is discharged outside.

In exclusive De'longhi water-air models, the heat is removed from the room through the cooling effect of the water which is obviously much greater than air.

This gives this air conditioner unbeatable cooling efficiency.

## **SAVE THESE INSTRUCTIONS**

THIS PRODUCT IS INTENDED FOR HOUSHOLD USE ONLY.

# DESCRIPTION

- A** Air outlet grille
- B** Control panel with advanced LCD display
- C** Handle
- D** Grille
- E** Castors
- F** Air intake grille with dust filter
- G** Condensate drain connector
- H** Power cable
- I** Tank door
- J** Pull out tank
- K** Air exhaust hose
- L** Remote control
- M** Air exhaust hose housing
- N** Window outlet
- O** Silver ion filter (certain models only)
- P** Electrostatic filter (certain models only)
- Q** Sucker
- R** Indicator paper
- S** Flange with cap
- T** Window bracket
- U** Water drain hose + cap

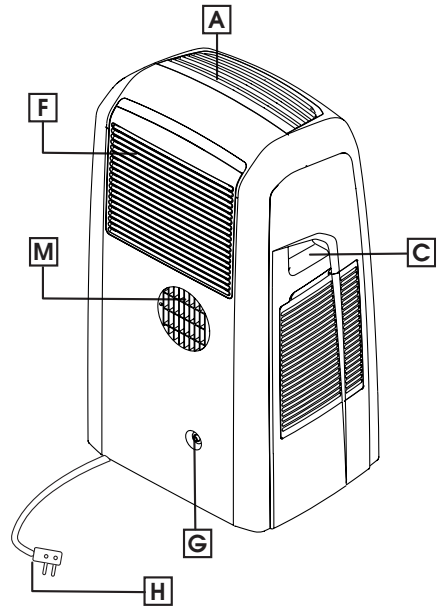
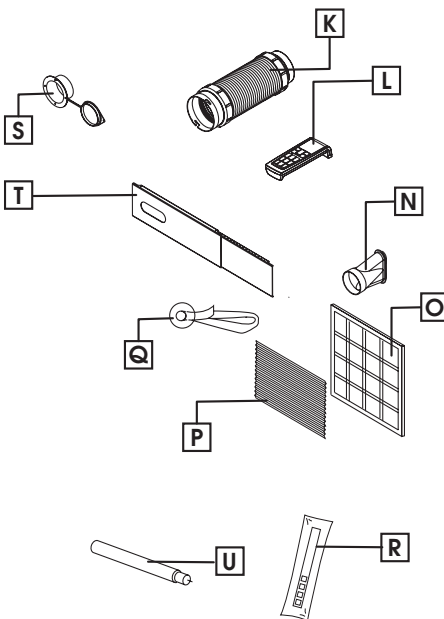
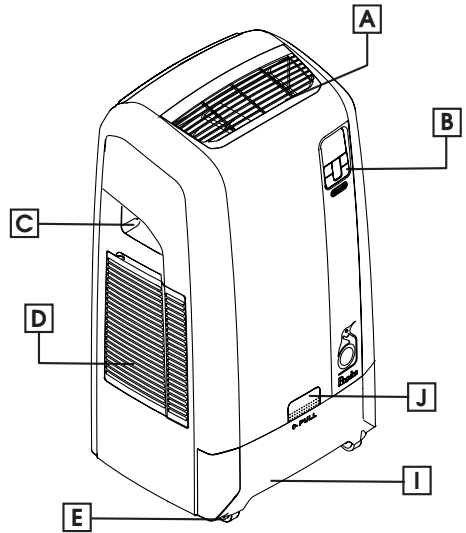

## PREPARING FOR USE

The instructions below will enable you to prepare your air conditioner for operation as efficiently as possible.

Before use, make sure the air intake and outlet grilles are unobstructed.

### Air-conditioning without installation

Just a few simple steps and your comfort is ensured with your appliance:

- Fit the air exhaust hose in the housing at the back of the appliance (fig. 1).

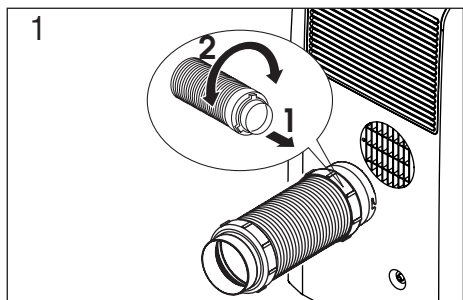

- Fit the window outlet (N) to the end of the hose (K).
- Place the air conditioner near a window or French window.
- Adjust the length of the hose to reach the window.
- Make sure the air exhaust hose is unobstructed.
- Open the window or French window slightly and position the outlet (fig. 2).

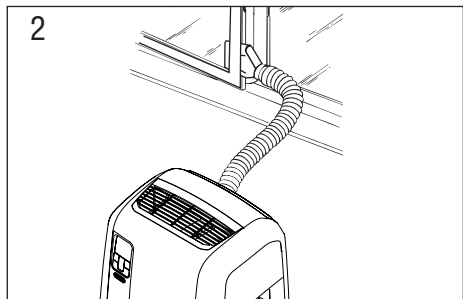

- If you have a double window, use the sucker (Q) provided to hold the two parts of the window together (fig. 3).

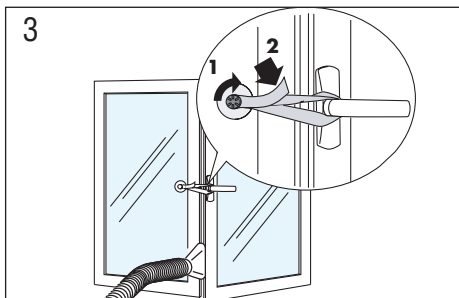

- If you have a sash window, place the window bracket (T) on the window sill, extend the window bracket fully within the window frame, fix the window bracket by using the locking pin then lower the window onto the window bracket. Insert the window outlet (N) of the exhaust hose (K) into the slot, then connect the hose to the air conditioner (fig. 4).

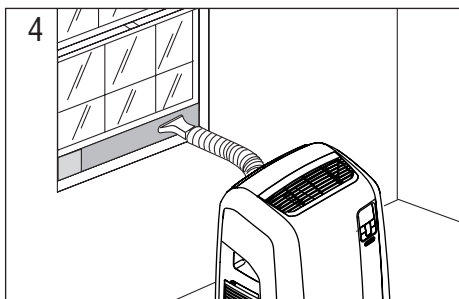

- Thanks to the locking pins, it's possible to use the window bracket also for sliding windows. Position the hole of the window bracket so to allow a correct installation of the exhaust hose (see figure 5).

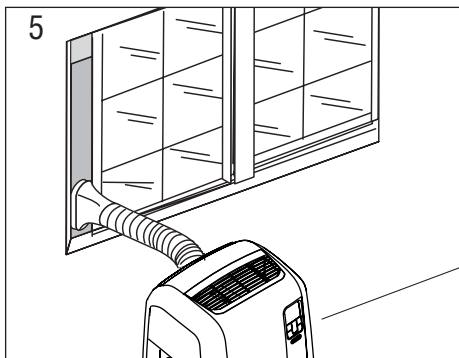

**i** Keep the air hose as short and free of curves as possible to avoid bottlenecks.

### Air-conditioning with installation

If required, your appliance can be installed semi-permanently (Fig. 6).

Proceed as follows:

- Drill a 5.27 inch (134 mm) dia. hole in an outside wall or through a window pane, respecting the heights shown in fig. 7.

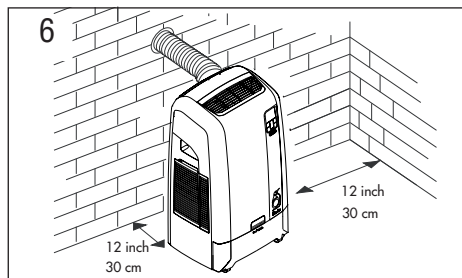

- Fit the flange accessory (S) provided in the hole following the indications in figs. 8, 9 and 10.

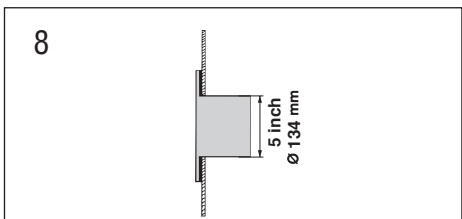
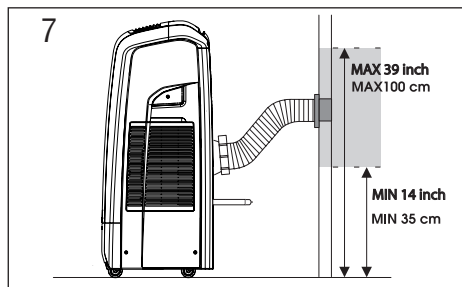

in the window pane

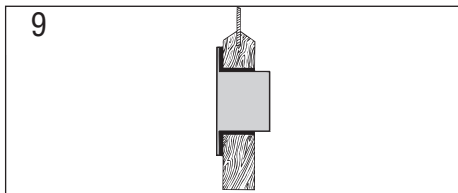

in the wooden kickboard of a French window

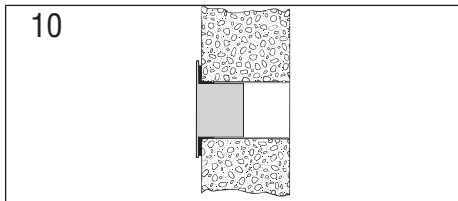

in the wall: you are recommended to insulate the section of wall using suitable insulation.

- Fit the air exhaust hose (K) in the housing at the back of the appliance (fig. 1).
- Fit the end of the hose to the flange (S). When the hose is not fitted, the hole can be closed with the flange cap.
- Remove the cap at the back of the appliance (G) and replace with the drain hose plus cap (U) as shown in figure 11. This enables the condensate to be drained more easily at the end of the season. See the section: "END OF SEASON OPERATIONS".

**i** Keep the air hose as short and free of curves as possible to avoid bottlenecks.

**i** When installing the air conditioner semi-permanently, you should leave a door slightly open, as little as 0.5 inch (1 cm), to guarantee correct ventilation.

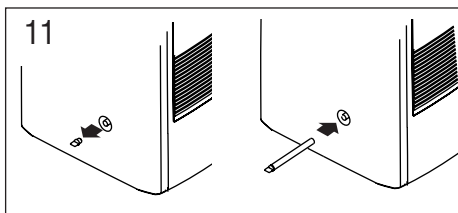

## PREPARING FOR OPERATION IN WATER MODE

Once the appliance has been installed, it is ready for use.

However, its efficiency can be enhanced by operating it in De'Longhi's patented water mode.

The water in the tank increases the cooling power of your Pinguino and at the same time reduces noise levels and electrical consumption.

Compared to air, water reduces the temperature of the cooling circuit much more efficiently, before being given off from the air exhaust hose in the form of vapour.

Remember that:

- You must always use salt-free clean water, tap water is recommended.
- The length of time the water in the tank lasts depends greatly on environmental conditions such as temperature, humidity, insulation, the sun exposure of the room, the number of people present, etc. As an estimate, the water lasts about six hours.

The BOOST function (see page 13) shortens the operating time to about 4 hours, but the cooling power and efficiency are increased.

- When the water in the tank runs out, the light  comes on and operation of the appliance switches automatically to air-air.

 **The appliance is fitted with a resin limescale filter enabling normal tap water to be used.**

**The resins reduce water hardness and therefore prolong the working life of the appliance.**







 **“CF” is displayed when the limescale filter needs replacing. The efficacy of the filter depends on water hardness. It should, however, be replaced every five years.**

### Setting water hardness

Measure water hardness using the indicator paper provided.

- Remove the indicator paper from its pack (R).
- Immerse the paper completely in a glass of water for one second.
- Remove the paper from the water and sha-

ke lightly. After about a minute, 1, 2, 3, 4 or 5 red squares appear, depending on the hardness of the water. The appliance can be set to three different water hardness levels soft (H1), medium (H2) and hard (H3). Determine the hardness of the water you will be using by comparing the red squares on the indicator paper with the table below.

Water hardness indicator	Level
<b>0 - 19°F Soft</b>   	<b>H1</b>
<b>20 - 36°F Medium</b>  	<b>H2</b>
<b>&gt; 36°F Hard</b> 	<b>H3</b>

To set water hardness, proceed as follows:

1. Set the appliance to stand-by.
2. Hold the **FAN** button on the control panel down for 10 seconds. The appliance emits a beep and **H1**, **H2** or **H3** is displayed.
3. Use the **+** or **-** buttons to set the hardness level according to the table below. Wait a few seconds for the setting to be memorized. The appliance emits another beep and goes back to stand-by.

 **The machine is set by default for medium hardness (H2).**

### Filling the tank

The water tank is located at the bottom of the appliance. Push in on the Tank Door (J) above the word **PULL**, and pull the tank out as far as it will go (fig. 12). Remove the cap and use a container (bottle, jug, watering can) to pour in the water (fig. 13/14). You can see when the tank is full through the filling hole. It holds a maximum of 21 pints (10 liters).

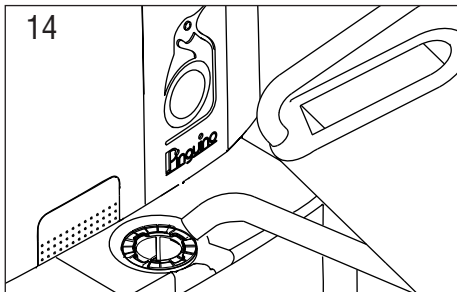
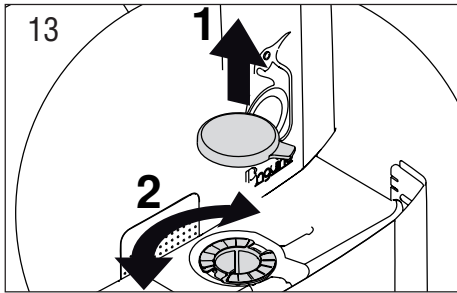
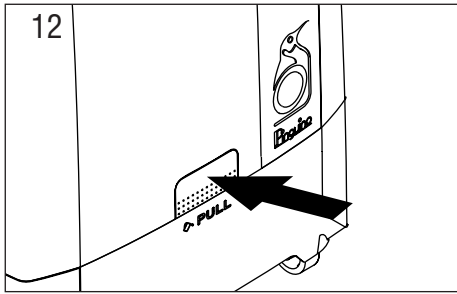

Replace the cap correctly and close the tank, pushing it in as far as it will go. The tank hole has a mesh filter to prevent the introduction of foreign matter. If necessary, this filter can be unscrewed and removed for cleaning under running water.

- The tank does not have to be full to use the water function, but the length of time the appliance will operate in water mode will be shorter.
- Do not fill above the level of the hole to avoid the water overflowing. The tank has no overflow prevention system.

## Replacing the limescale filter

Turn the appliance off and unplug it from the outlet.

Make sure there is no water in the appliance by emptying the tank and internal tray as described in the section: “End of season operations”.

Lay the appliance on its back as shown in figure 16. Rest it on a towel or piece of cardboard to avoid scratches or damage. Remove the filter cover by unscrewing the four screws (fig. 16).

Remove the filter delicately and loosen the two ties, making sure the two hoses connecting the filter do not slip inside the appliance. Fit the new filter, following the same procedure in reverse (fig. 16-17). The notch on the filter (see figure 15) indicates the correct direction. The notch must always be towards the inside of the appliance and point “A” must be facing upwards.

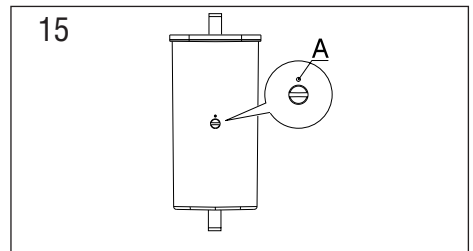

**i** Water may leak out while replacing the limescale filter. You should therefore perform the operation in a suitable location.

**i** After replacing the filter, wait at least an hour before starting the machine again.

**i** When the filter has been replaced, turn the alarm off by pressing the ON/STAND-BY button (15) for 10 seconds. The appliance emits a beep.



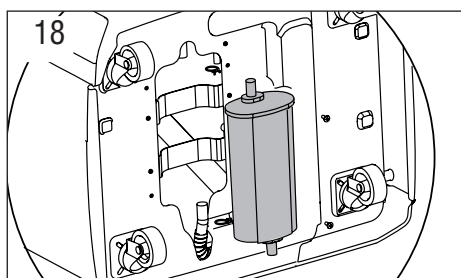
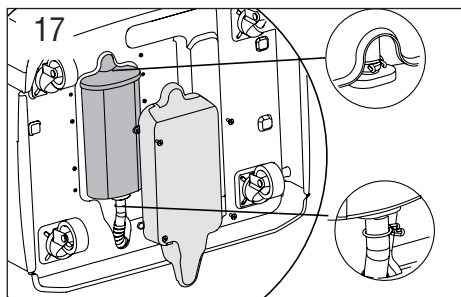
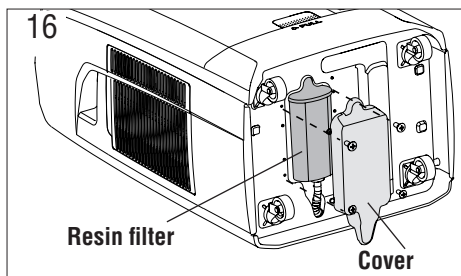

## DESCRIPTION OF THE CONTROL PANEL WITH ADVANCED LCD DISPLAY

- 1 Air conditioning symbol
- 2 Dehumidifying symbol
- 3 Fan symbol
- 4 SMART symbol
- 5 BOOST symbol
- 6 SLEEP symbol
- 7 Alarm symbol
- 8 Temperature indicator
- 9 "No water" symbol
- 10 Timer symbol
- 11 Fan speed indicator
- 12 AUTOFAN indicator
- 13 FAN button
- 14 Increase (+) and decrease (-) temperature buttons

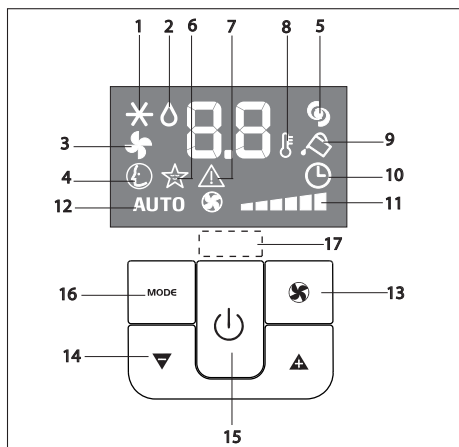

- 15 ON/Standby button
- 16 MODE button (selects the modes)
- 17 Signal receiver



## OPERATING FROM THE CONTROL PANEL

The control panel enables you to manage all the main functions of the appliance, however some functions are only available through the use of the remote control.

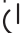
### Turning the appliance on

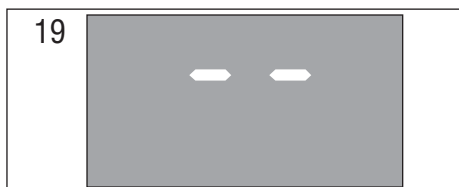

- Plug into the outlet and check the black cap is fully inserted.
  - Two lines appear on the display indicating that the appliance is in standby (fig. 19).
- Press the  button until the appliance comes on. The last function active when it was turned off will appear.
- Never turn the air conditioner off by unplugging from the outlet. Always press the  button, then wait for a few minutes before unplugging. This allows the appliance to perform a cycle of checks to verify operation.



## **Air conditioning mode (fig. 20)**

Ideal for hot muggy weather when you need to cool and dehumidify the room.

To set this mode correctly:

- Press the **MODE** button a number of times until the air-conditioning symbol appears.
- Select the target temperature by pressing the  or  button until the corresponding value is displayed.
- Select the required fan speed by pressing the  button.

Four speeds are available:

 **Maximum speed:** to achieve the target temperature as rapidly as possible

 **Medium speed:** reduces noise levels while maintaining a comfortable temperature

 **Low speed:** for quiet operation and maximum energy efficiency

 **AUTOFAN:** the appliance automatically selects the most suitable fan speed in relation to the temperature set on the digital display.

*The most suitable temperature for the room during the summer varies from 75-80 °F (24-27 °C).*

*You are recommended, however, not to set a temperature much below the outdoor temperature.*

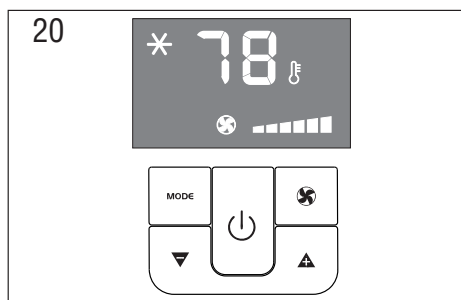

## **Dehumidifying mode (fig. 21)**

Ideal to reduce room humidity (spring and autumn, damp rooms, rainy periods, etc).

In dehumidifying mode, the appliance should be prepared in the same way as for air conditioning, **with the air exhaust hose attached** to enable the moisture to be discharged outside. The moisture collected during dehumidification IS NOT collected in the front tank.

To set this mode correctly:

- Press the **MODE** button a number of times until the dehumidifying symbol appears.

 *In this mode, fan speed is selected automatically by the appliance and cannot be set manually.*

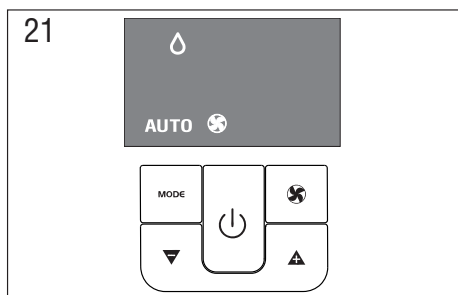

## **Fan mode (fig. 22)**

When using the appliance in this mode, the air hose does not need to be attached.

To set this mode correctly:

- Press the **MODE** button a number of times until the fan symbol appears.
- Select the required fan speed by pressing the  button.

Three speeds are available:

 **High speed**

 **Medium speed**

 **Minimum speed**

*In this mode, AUTO speed cannot be selected.*

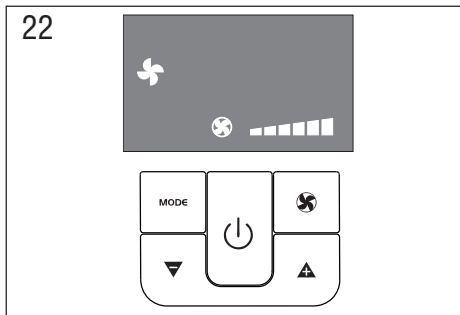

 **SMART mode (fig. 23)**

SMART mode creates ideal comfort conditions in the room. The appliance automatically establishes whether to operate in air conditioning, fan or stand-by mode depending on the environmental conditions detected.

To set this mode:

- Press the **MODE** button a number of times until the **SMART** symbol appears.
- Choose the required fan speed.

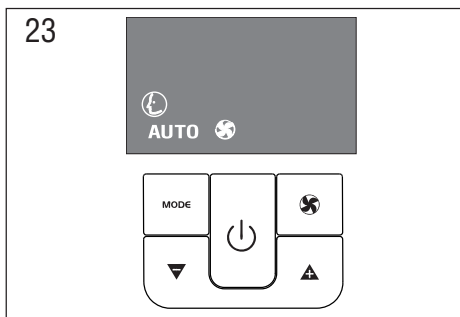

**DESCRIPTION OF THE REMOTE CONTROL**

- 1 Air conditioning symbol
- 2 Dehumidifying symbol
- 3 Fan symbol
- 4 SMART symbol
- 5 Selected temperature scale indicator
- 6 Signal transmission
- 7 BOOST symbol
- 8 SLEEP symbol
- 9 AUTOFAN indicator
- 10 Fan speed indicator

- 11 TIMER ON symbol
- 12 Timer OFF symbol
- 13 Clock
- 14 ON/Standby button
- 15 FAN button
- 16 Increase (+) and decrease (-) temperature buttons
- 17 MODE button (selects the modes)
- 18 Reset button (resets the appliance to the original settings)
- 19 OK button
- 20 Timer OFF button
- 21 °C or °F selection button
- 22 SLEEP button
- 23 BOOST button
- 24 Timer ON button

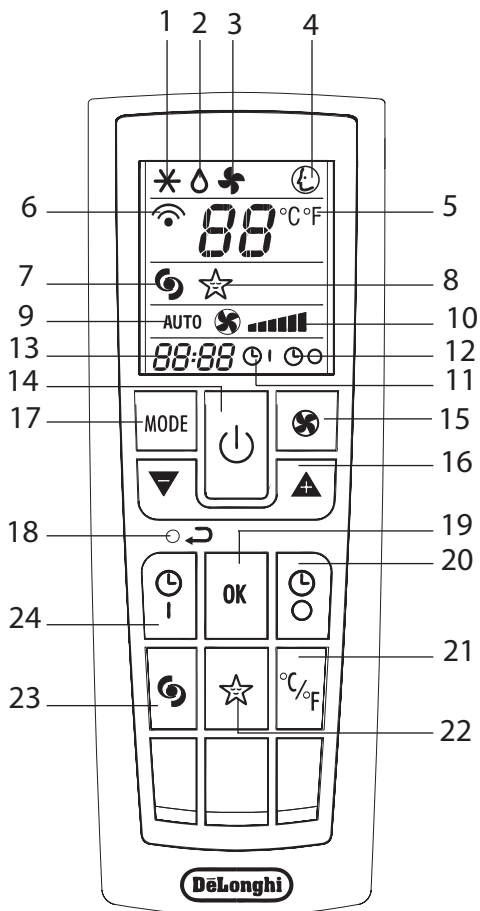

## USING THE REMOTE CONTROL

- Point the remote control at the receiver on the appliance. The remote control must be no more than 23 ft (7 meters) away from the appliance (without obstacles between the remote control and the receiver).
- The remote control must be handled with extreme care. Do not drop it or expose it to direct sunlight or sources of heat.

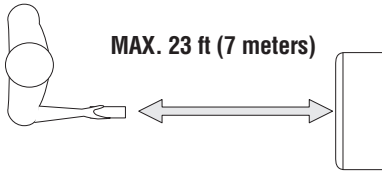

## Inserting or replacing the batteries

- Remove the cover on the rear of the remote control (fig. 24);
- Insert two “AAA” 1.5V batteries in the correct position (see instructions inside the battery compartment);
- Replace the cover.

**i** If the remote control unit is replaced or disposed of, the batteries must be removed and discarded in accordance with current legislation as they are harmful to the environment.

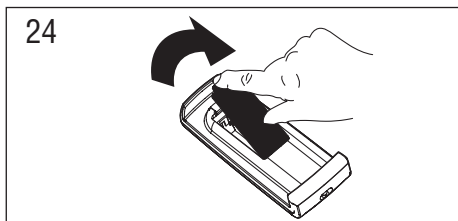

## Setting the time

After inserting the batteries, the clock on the display flashes until the time is set.

Proceed as follows.

- Press the **▲** or **▼** button until the correct time is reached.  
Hold the button down to run rapidly through first the minutes, then the tens of minutes.
- Once the correct time has been reached, re-

lease the button and press the **OK** button to confirm.

- To cancel the settings programmed on the remote control and restore the original settings, press the **○ ↶** button lightly with the point of a pencil or pen.

## USING THE REMOTE CONTROL UNIT

The first part of the controls on the remote control are the same as those on the control panel of the appliance (fig. 25).

You should therefore refer to the instructions in the chapter OPERATING FROM THE CONTROL PANEL to

- turn the appliance on or off and
- select the operating mode (air conditioning, dehumidifying, fan or Smart) and the fan speed.
- set the required temperature.

The following section describes the additional functions corresponding to the controls on the bottom part of the remote control.

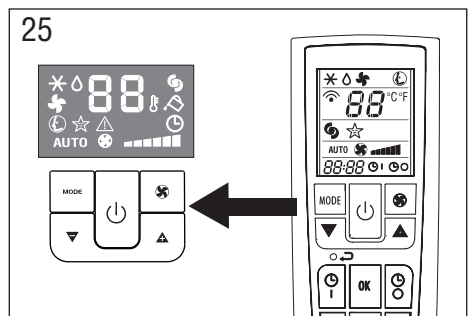



### BOOST function (fig. 26)

Ideal for the summer to cool rooms rapidly. Activate by simply pressing the  button. The appliance operates in air conditioning mode at maximum fan speed and maximum power. While this function is selected, it is not possible to set the temperature or change fan speed.

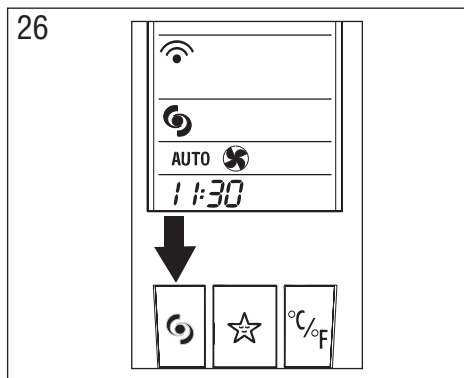

When the BOOST function is active, the water lasts less time than in air conditioning mode. On the other hand, the cooling power and efficiency of the appliance are higher.

### Selecting the temperature scale (fig. 27)

Press the  button to switch the temperature display from °C to °F and vice versa.

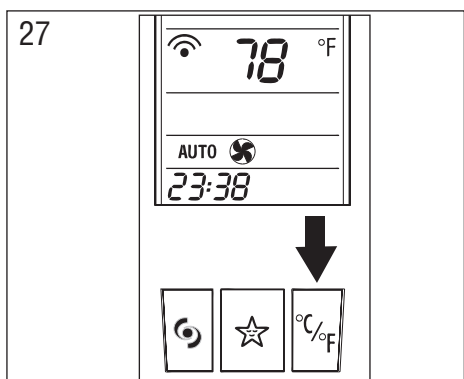

### Sleep function (fig. 28)

This function is useful for the night as it gradually reduces operation of the appliance, turning it off after 8 hours.

To set this function:

- Select the operating mode (air conditioning, dehumidifying, smart) as described above.
- Press the  button.

The appliance operates in the previously selected mode with the lowest possible fan speed.

Fan speed is always at minimum, while room temperature and humidity vary gradually to ensure the most comfortable conditions.

During air conditioning, the temperature increases by 1°C after 60 minutes and a further 1°C after 2 hours.



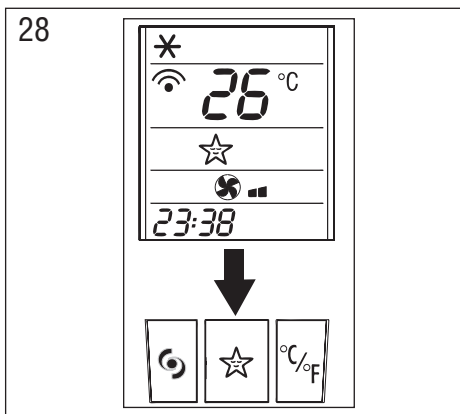



In dehumidifying mode, the dehumidifying power of the appliance is partially reduced every hour for the first two hours.







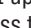

## PROGRAMMING THE TIMER

The timer can be programmed to start and stop the appliance when required.

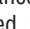

### Programming start up

- Press the  button.  
The start-up time and symbol  flashes on the remote control display (fig. 29).
- Press the  or  buttons to set the time you want the appliance to start up.
- When that time is reached, press the OK button to confirm (fig. 30). The symbol  remains displayed on the remote control and the  symbol is displayed on the appliance to indicate that the timer is active.

### Programming shutdown

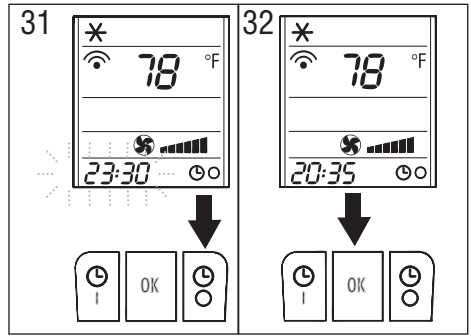
- Press the  OFF button. The shutdown time and symbol  flashes on the remote control display (fig. 31).
- Press the  or  buttons to set the time you want the appliance to shut down.
- When that time is reached, press the OK button to confirm (fig. 32). The symbol  remains displayed on the remote control and the  symbol is displayed on the appliance to indicate that the timer is active.





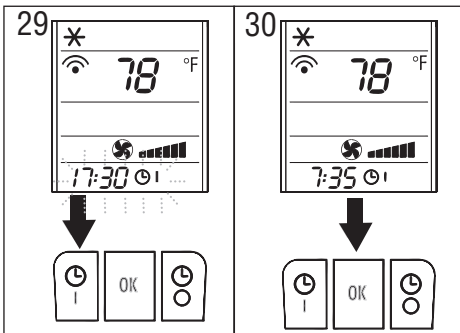

If you need to disable the timer program (on or off) in advance, press the  or  button respectively twice.



## SELF-DIAGNOSIS

The appliance has a self diagnosis system to identify a number of malfunctions.  
Error messages are displayed on the appliance display.

IF ... IS DISPLAYED,	...WHAT SHOULD I DO?
 <p><b>Low Temperature</b> (frost prevention)</p>	<p>The appliance is fitted with a frost protection device to avoid excessive formation of ice. The appliance starts up again automatically when the defrosting process is completed.</p>
 <p><b>High Level</b> (internal tray full)</p>	<p>Empty the internal safety tank following the instructions in the section "End of season operations". If it reoccurs, contact your local authorized service center.</p>
 <p><b>Change filter</b></p>	<p>When this message is displayed, the water filter needs replacing as described in the section: "Replacing the limescale filter".</p>

IF ... IS DISPLAYED,	...WHAT SHOULD I DO?
 <p><b>Probe Failure</b> (sensor damaged)</p>	<p>If this is displayed, contact your local authorized service center.</p>
 <p><b>Failure1</b></p>	<p>When the F1 alarm is active, the appliance continues functioning normally in air-air mode. To reset the alarm, unplug the appliance then plug in again. If the alarm reoccurs frequently, contact customer services.</p>

## TIPS FOR CORRECT USE

To ensure optimal results from your air conditioner, follow these recommendations:

- close the windows and doors in the room to be air conditioned (fig. 33).

When installing the air conditioner semi-permanently, you should leave a door slightly open (as little as 0.39 inch. (1 cm)) to guarantee proper ventilation.

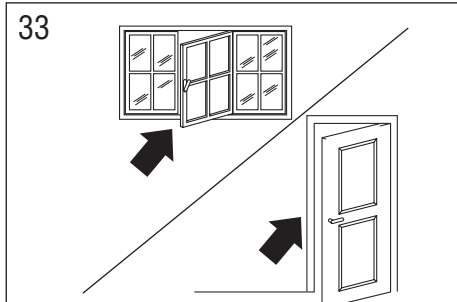

close doors and windows

- Protect the room from direct exposure to the sun by partially closing curtains and/or blinds to make the appliance much more economical to run (fig. 34);

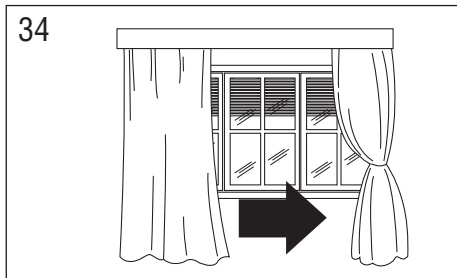

close curtains

- never rest objects of any kind on the air conditioner;
- do not obstruct the air intake and outlet (fig. 35). Leave both grilles free;
- make sure there are no heat sources in the room;
- never use the appliance in very damp rooms (laundry rooms for example);
- never use the appliance outdoors;

35

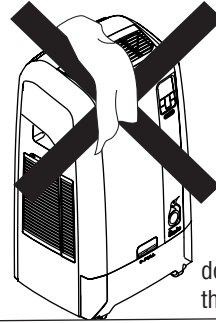

do not cover the appliance

- make sure the air conditioner is standing on a level surface.  
If necessary, place the castor locks under the front wheels.

## AIR PURIFYING FILTERS

This appliance is fitted with two dust filters to maintain efficiency.

One is at the back near the intake grille, the other is at the side (fig. 36-37).

36

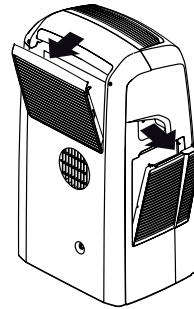

37

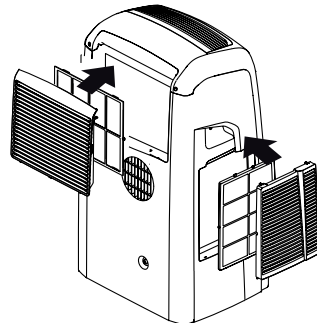



Certain models have a silver ion dust filter and an additional electrostatic filter in the grill at the back

### Silver ion filter

This dust filter is treated with silver ions which not just retain dust particles, but also have an efficient antibacterial action. It also greatly reduces concentrations of irritants such as pollen and spores.

### Electrostatic filter

The electrostatic filter retains the finest dust particles, thus enhancing the filtering capacity of the appliance.

### Fitting the filters to the grille

The appliance can be used with only the dust filters inserted in the grille.

To use the two supplementary filters (if provided with your model), remove them from the packaging and attach them to the dust filter, inserting them under the special clips (fig. 38).

If you decide not to use it, keep it sealed in the packaging.

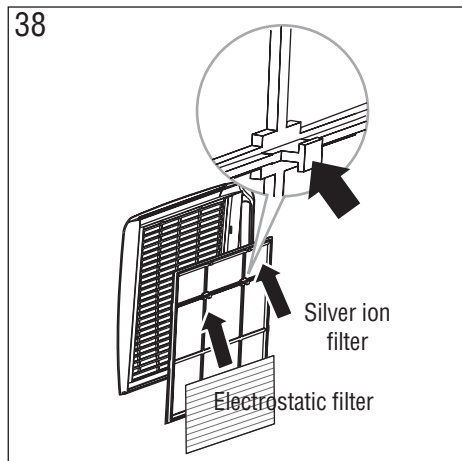

## CLEANING

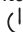
Before cleaning or maintenance, turn the appliance off by pressing the  button on the control panel or remote control, wait for a few seconds then unplug from the outlet.

### Cleaning the cabinet

You should clean the appliance with a slightly damp cloth then dry with a dry cloth.

- Do not wash the air conditioner with water. It could be dangerous.
- Do not use petrol, alcohol or solvents to clean the appliance.  
Do not spray insecticide liquids or similar solutions.

### Cleaning the air filters

To keep your air conditioner working efficiently, you should clean the dust filters every week during operation.

### Cleaning the dust filters supplied with all models

Each filter is housed in the intake grille.

To clean the filters, proceed as follows

- Remove the intake grille by pulling it outwards (fig. 36).
- Remove the dust filter by detaching it from the grille (Fig. 37).
- Use a vacuum cleaner to remove the dust collected on the filter.  
If it is very dirty, immerse in warm water and rinse a number of times.
- After washing, leave the filter to dry completely.
- To replace, put the filters back in the intake grille then attach the intake grille to the appliance.

## Cleaning of the silver ion filter and of the electrostatic filter (certain models only)

To clean the silver ion dust filter, the electrostatic filter must be temporarily removed.

To clean the filters, use a vacuum cleaner at medium power.

The silver ion filter can be washed with lukewarm water. Leave to dry completely and replace.

The electrostatic filter is not washable but it should be replaced at least once every two seasons.

The electrostatic filter can be bought from shops selling De'longhi accessories or authorized service centers.

## START OF SEASON OPERATIONS

Make sure the power cable and plug are undamaged and the electrical system is efficient. Follow the set-up/installation instructions precisely.

## END OF SEASON OPERATIONS

Before putting the appliance away or moving it to another location, empty any water left in the tanks.

### Emptying the tank

Pull out the tank as described in the section: "FILLING THE TANK". Unhook the drain hose on the left of the tank (fig. 39-40) and place the end in a receptacle. Remove the cap and drain off the water left in the tank.

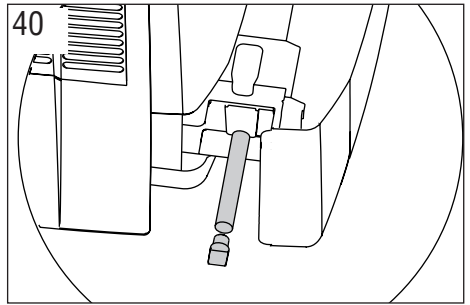
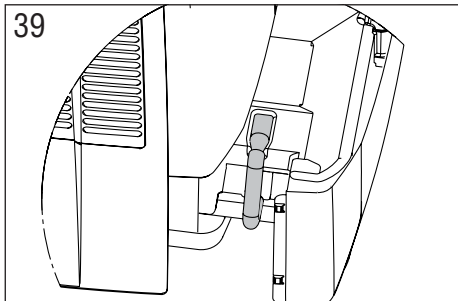

### Emptying the internal tank

To facilitate this operation, at the start of the season, replace the spout cap (G) with the drain hose + cap (U).

Place a receptacle (such as a jug or bottle) near the spout on the back of the appliance (fig. 41). Remove the cap and run off any water left.

When completely empty, replace the cap.

**IMPORTANT:** the tank could contain as much as 4 pints (2 litres) of water.

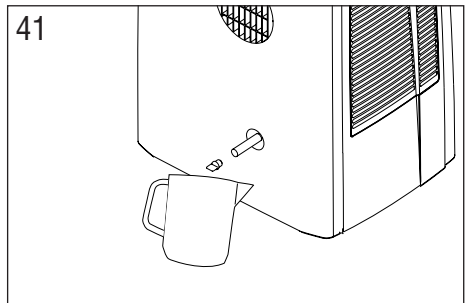

- After performing the 2 operations described above, operate the appliance in fan only mode for about half an hour. This dries any water remaining inside the appliance.
- Turn the appliance off and unplug from the outlet.
- Remove the air exhaust hose and condensate drain hose.
- Clean the dust filters.
- Cover the appliance to avoid dust.

## **TECHNICAL CHARACTERISTICS:**

Power supply voltage see rating plate

Maximum absorbed power  
in air conditioning “

Refrigerant “

Cooling capacity “

## **Limit conditions**

Room temperature for air conditioning 70÷95 °F  
(21÷35°C)

## **GUARANTEE**

The terms of the guarantee and technical assistance are given in the documentation accompanying your appliance.

Transport, filling, cleaning, recovery and disposal of refrigerant should be performed by a technical service centre appointed by the manufacturer only.

The appliance should be disposed of by a specialist centre appointed by the manufacturer only.

NEVER TRANSPORT OR TURN THE APPLIANCE UPSIDE DOWN OR ON ITS SIDE. IF THIS OCCURS, WAIT 6 HOURS BEFORE TURNING THE APPLIANCE ON, 24 HOURS IS RECOMMENDED. (After the unit has been on its side, oil needs to return to the compressor to ensure proper function. Without allowing the unit this time (6-24 hours) The unit may function for only a short time, and then the compressor will break down from lack of oil).

This appliance is equipped with a 3 prong grounded plug. The plug must be connected into an outlet that is properly installed and grounded in the accordance with all local codes and ordinances. Do not modify the plug provided with the appliance. If it will not fit the outlet, have a proper outlet installed by a qualified electrician or relocate the unit to a proper outlet.

If the household electrical supply does not meet the above specifications, or if you are not sure your home has an effective electrical ground, have a qualified electrician or your local electrical utility company check it and correct any problems.

### **SAFETY PLUG**

The appliance is fitted with a safety plug to protect the power cable.

If power is cut off, unplug from the outlet and make sure the power cable is undamaged.

If the cable is damaged, call the service center immediately.

If power cuts off frequently and the power cable is undamaged, contact a qualified electrician.

### **OPERATION OF THE SAFETY PLUG**

If the safety device incorporated in the plug trips and cuts off the power supply, check that the power cable and plug are not damaged.

If the power cable is undamaged, to restore operation press the “RESET” button.

To verify correct operation of the plug, press the “TEST” button periodically and make sure the appliance disconnects. If this is not the case, contact the service center.

To restore operation, press the “RESET” button.

## TROUBLESHOOTING

PROBLEM	CAUSE	SOLUTION
The air conditioner does not come on	<ul style="list-style-type: none"> <li>there is no current</li> <li>it is not plugged into the outlet</li> <li>the internal safety device has tripped</li> </ul>	<ul style="list-style-type: none"> <li>wait</li> <li>plug into the outlet</li> <li>call the Service Center</li> </ul>
The air conditioner works for a short time only	<ul style="list-style-type: none"> <li>there are bends or kinks in the air exhaust hose</li> <li>something is preventing the air from being discharged</li> </ul>	<ul style="list-style-type: none"> <li>position the air hose correctly, keeping it as short and free of curves as possible to avoid bottlenecks.</li> <li>check and remove any obstacles obstructing air discharge</li> </ul>
The air conditioner works, but does not cool the room	<ul style="list-style-type: none"> <li>windows, doors and/or curtains open</li> <li>there are heat sources in the room (oven, hairdryer, etc)</li> <li>the air exhaust hose is detached from the appliance</li> <li>dust filters clogged</li> <li>the technical specification of the appliance is not adequate for the room in which it is located.</li> </ul>	<ul style="list-style-type: none"> <li>close doors, windows and curtains, bearing in mind the "TIPS FOR CORRECT USE" given above</li> <li>eliminate the heat sources</li> <li>fit the air exhaust hose in the housing at the back of the appliance (fig. 1).</li> <li>clean or replace the filters as described above</li> </ul>
During operation, there is an unpleasant smell in the room	<ul style="list-style-type: none"> <li>dust filter and (when present) electrostatic filter clogged</li> </ul>	<ul style="list-style-type: none"> <li>clean the filters as described above</li> </ul>
The air conditioner does not operate for about three minutes after restarting it	<ul style="list-style-type: none"> <li>the internal compressor safety device prevents the appliance from being restarted until three minutes have elapsed since it was last turned off.</li> </ul>	<ul style="list-style-type: none"> <li>wait. This delay is part of normal operation.</li> </ul>
The symbol  and one of the following messages <i>LT / HL / CF / PF / FI</i> appears on the appliance display:	<ul style="list-style-type: none"> <li>The appliance has a self diagnosis system to identify a number of malfunctions.</li> </ul>	<ul style="list-style-type: none"> <li>See the SELF-DIAGNOSIS chapter.</li> </ul>

De'Longhi is the distributor of Kenwood home appliances.

This warranty applies to all home appliances with De'Longhi or Kenwood brand names

### **Limited Warranty**

We warrant each De'Longhi AIR CONDITIONER to be free from defects in material and workmanship. From the purchase date, our obligation under this warranty is to provide one (1) year free parts and labor on the entire AIR CONDITIONER, with an additional four (4) years free on any part of the sealed system consisting of the compressor, evaporator, condenser and factory connected refrigerant tubing. Labor and all other parts during the additional four (4) year warranty are to be paid by the owner. All AIR CONDITIONERS in need of repair are to be shipped to an authorized De'Longhi service center at the owner's expense, and De'Longhi will then incur the return shipping costs. After the first five (5) years of ownership, all expenses (all parts, labor and shipping) are to be paid by the owner of the unit. This warranty shall apply only if the AIR CONDITIONER is used in accordance with the factory directions that accompany it, and on an Alternating Current (AC) circuit. This warranty is in lieu of all other warranties and representations, expressed or implied, and all other obligations or liabilities on our part. We do not authorize any other person or company to assume for us any liability in connection with the sale or use of our AIR CONDITIONER. This warranty shall not apply to any AIR CONDITIONER that has been repaired or altered outside our factory nor shall it apply to any AIR CONDITIONER that has been subjected to misuse, negligence or accidents.

If repairs become necessary, see contact information below:

#### **U.S. Residents:**

Please contact our toll free hotline at **1-800-322-3848**  
or log onto our website at **www.delonghi.com**

#### **Residents of Canada:**

Please contact our toll free hotline at **1-888-335-6644**  
or log onto our website at **www.delonghi.com**

#### **Mexico Residents:**

Please contact our toll free hotline at **01-800-711-8805**  
or log onto our website at **www.delonghi.com**

The above warranty is in lieu of all other express warranties and representations. All implied warranties are limited to the applicable warranty period set forth above. This limitation does not apply if you enter into an extended warranty with De'Longhi. Some states/countries do not allow limitations on how long an implied warranty lasts, so the above exclusions may not apply to you. De'Longhi does not authorize any other person or company to assume for it any liability in connection with the sale or use of its appliance.

#### **How does country law apply?**

This warranty gives you specific legal rights, and you may also have other rights, which vary from state to state/country to country. This warranty gives you specific legal rights, and you may also have other rights, which vary from state to state/country to country.